

Sample Site Plan

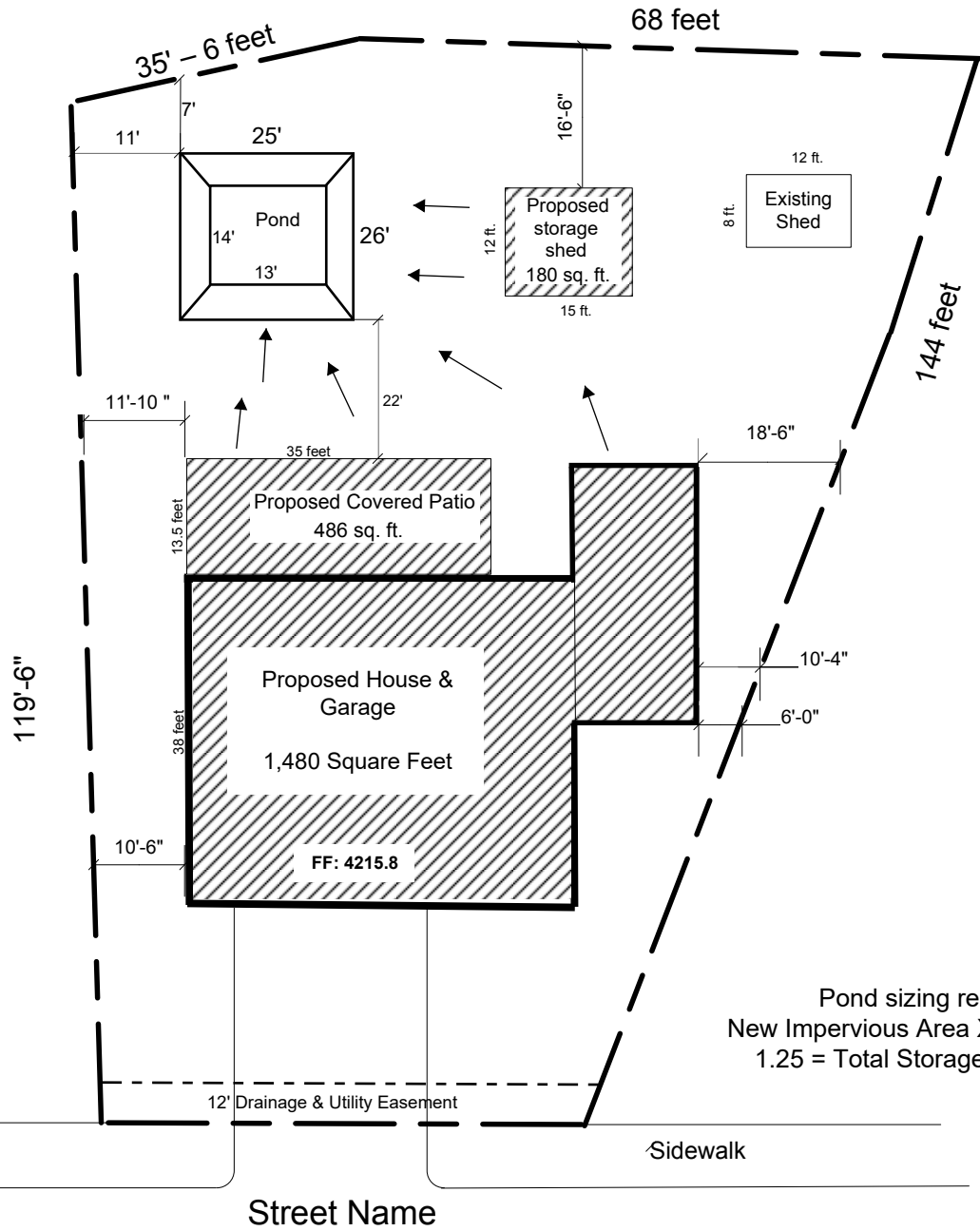

Pond sizing requirements:
 $\text{New Impervious Area} \times (2.8/12) \times 1.25 = \text{Total Storage required in Cubic Feet.}$

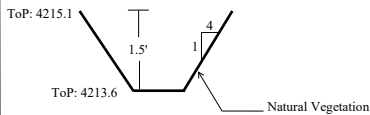

Pond Detail

Description of proposed work:
 Proposed House = 1,480 square feet
 Proposed Patio = 486 square feet
 Proposed Shed = 180 square feet

Property Owner Name:
 Project Address:

